

# 6000EL QUICK INSTALLATION GUIDE

1

Remove box from pallet.



2

Using a ½” wrench, remove the shipping bolts and place the chair in its final location.

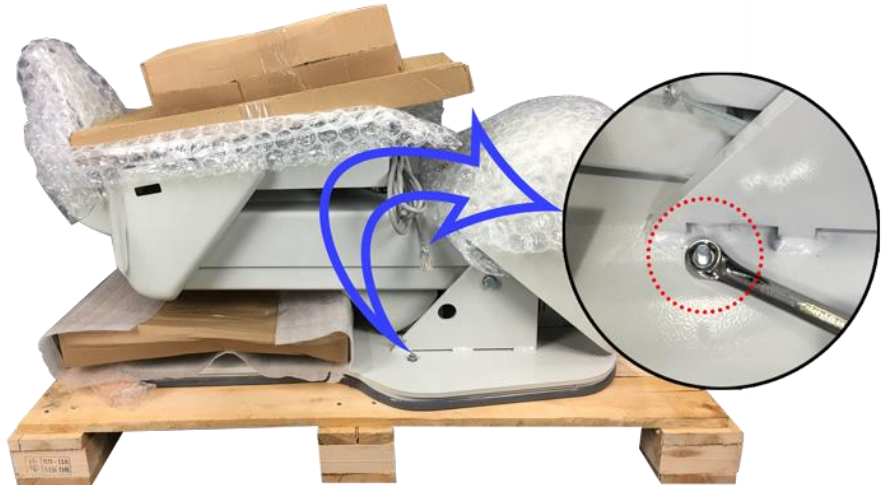

3

Unpack and install armrests. You may now connect the chair to a power source. NOTE: Determine where the swivel arm is going to be installed left or right side.

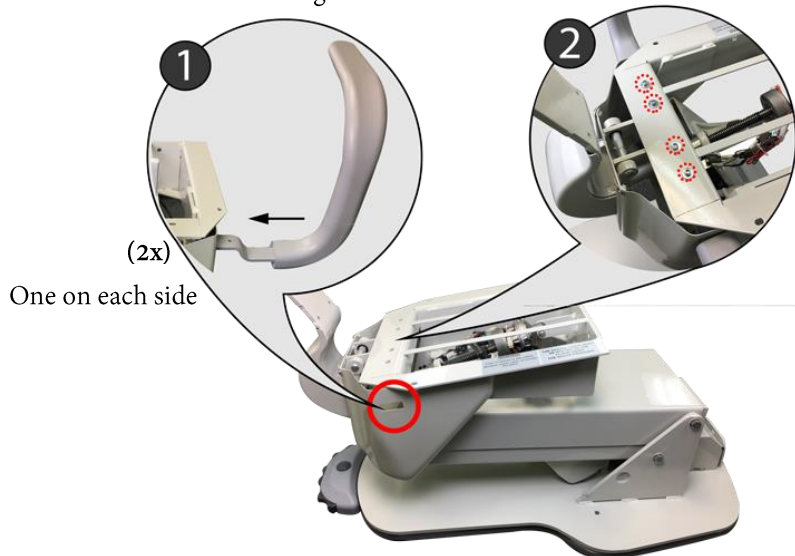

4

Lower backrest articulation bracket (1), and install the backrest frame (2) using four ¼”-20 bolts (3). NOTE: Use the chair functions to adjust the chair position to ease installation.

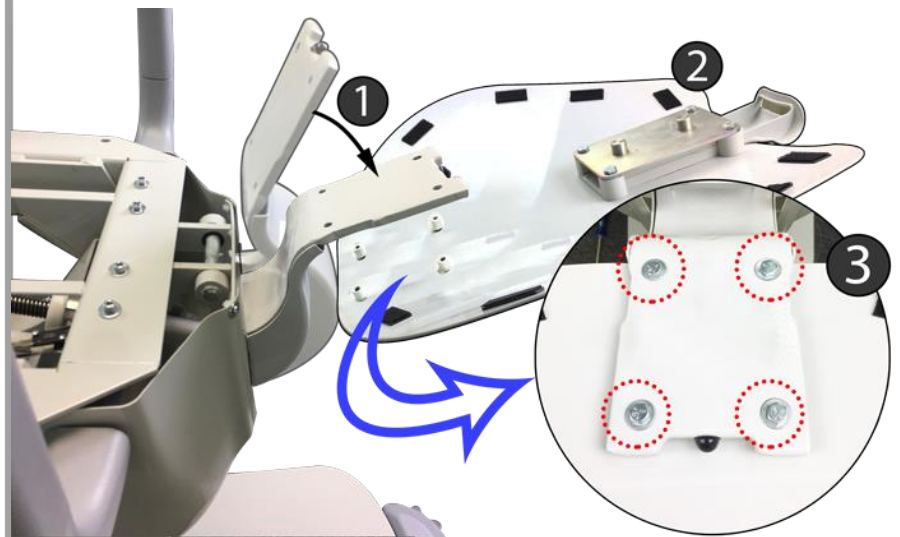

## 6000EL QUICK INSTALLATION GUIDE

5

Install toe pan using two sets of 3/8" bolts, nuts and washers.

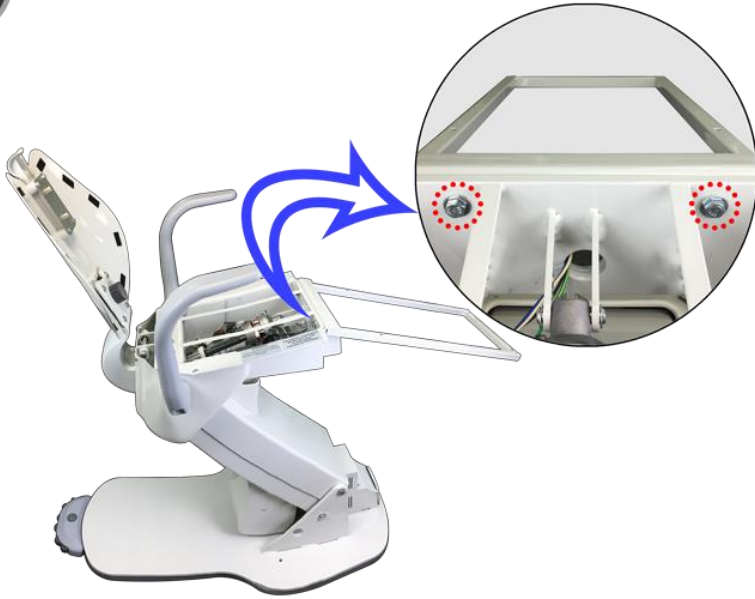

6

Install cover using three Philips screws.



7

Put the headrest in position as shown in the image.

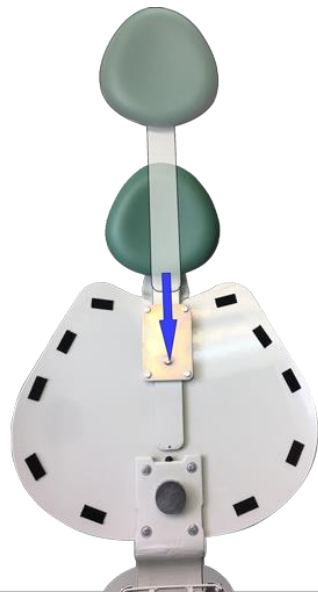

8

Lower backrest, align back cushion on frame, apply pressure on areas indicated until Velcro locks in place.

